



Register today for

Event details and registration form enclosed!



MARCH 2-4  
**SAN ANTONIO**  
 2017

632 Cepi Drive  
 Chesterfield, MO 63005

REGISTER EARLY AND SAVE!  
 CommodityClassic.com

COMMODITY CLASSIC IS THE PREMIER CONVENTION AND TRADE SHOW OF THE AMERICAN SOYBEAN ASSOCIATION, NATIONAL CORN GROWERS ASSOCIATION, NATIONAL ASSOCIATION OF WHEAT GROWERS, NATIONAL SORGHUM PRODUCERS AND ASSOCIATION OF EQUIPMENT MANUFACTURERS.



AMERICA'S LARGEST FARMER-LED, FARMER-FOCUSED CONVENTION & TRADE SHOW

Commodity Classic is the premier convention and trade show of the American Soybean Association, National Corn Growers Association, National Association of Wheat Growers, National Sorghum Producers and Association of Equipment Manufacturers.

**COMMODITY CLASSIC HAS IT ALL!**

- High-Powered Education
- Thought-Provoking Discussions
- Expert Speakers
- Top National Talent
- New Technology & Ideas
- Incredible Trade Show
- Opportunities to meet other growers from across the nation

CommodityClassic.com

It doesn't matter what crop you raise. When you attend Commodity Classic, you're sure to raise your expectations for your farm.



## Times are challenging in agriculture. So get ready to “Farmer Up!” at Commodity Classic.

Success in tough times takes a little extra effort, insight and fortitude. Attending the 2017 Commodity Classic is a great way to “Farmer Up!” and strengthen the position of your operation by getting even smarter, more efficient and more profitable.

It doesn't matter if you raise corn or cotton, soybeans or peanuts, wheat or sorghum—Commodity Classic is where you'll find the answers, ideas, innovation, technology, equipment and expertise that can make a powerful difference on your farm. This is where early adopters get the inside track on what's new. It's where the world's best agriculture companies bring their best equipment, technology and people. It's where thousands of America's best farmers share their passion for agriculture.

**Commodity Classic is America's largest farmer-led, farmer-focused convention and trade show. It's unlike any other farm show you've ever seen. Investing a few days at Commodity Classic will pay dividends on your farm all year long!**



## Always the Innovator, Never the Imitator®

For over 70 years NACHURS® has been helping farmers achieve higher yields and profits, offering premium liquid in-furrow starters, foliar nutrition, and micronutrients.

**For the latest fertilizer technologies see us at Commodity Classic, Booth #554.**



visit us online: [www.nachurs.com/comclassic](http://www.nachurs.com/comclassic) or call: 800.622.4877 x 255

© 2016. NACHURS ALPINE SOLUTIONS. All rights reserved.

## Why Commodity Classic is the one “can’t-miss” farm event of the year:

**Farmer-led. Farmer-focused. It matters.** Commodity Classic is created by farmers, for farmers. So you know that every educational session, every presentation, every experience is designed to help you get the answers, information, ideas and inspiration you’re looking for.

**Education that will change the way you think about your farm.** Regardless of what you grow, you’ll learn something that will impact your success. Check out the incredible line-up of educational sessions on the schedule.



### Where America’s best ag companies bring their best.

Agribusiness knows that Commodity Classic attracts the nation’s leading farmers. So this is where they showcase their newest technology, equipment and innovation—and they bring their top people to talk with you, one-on-one.

### The new ideas you won’t find at your local farm show.

Take time to explore the hundreds of smaller exhibits on the trade show floor. You’re bound to find the emerging innovation or groundbreaking product that could change the way you farm.

### Be among thousands of America’s best farmers. Just like you.

Meeting other leading farmers from across the nation is one of the top-rated experiences at Commodity Classic. You’ll be energized by being among top producers who share your passion for agriculture and your thirst for knowledge.

**MARCH 2-4**  
**SAN ANTONIO**  
**2017**



## 2017 Schedule at a Glance

Commodity Association schedule on page 4

### WEDNESDAY, MARCH 1

#### Optional Tours

8:00 a.m. - 7:00 p.m.	Registration Desk Open
5:00 p.m. - 7:00 p.m.	Welcome Reception

### THURSDAY, MARCH 2

#### Optional Tours

6:45 a.m. - 6:30 p.m.	Registration Desk Open
7:00 a.m. - 8:00 a.m.	Education: Early Riser Session
8:30 a.m. - 10:00 a.m.	Education: Mini What’s New Sessions
8:30 a.m. - 10:00 a.m.	Education: Learning Center Session
10:15 a.m. - 11:45 a.m.	Education: Mini What’s New Sessions
10:15 a.m. - 11:45 a.m.	Education: Learning Center Session
12:30 p.m. - 1:30 p.m.	Media-Only Trade Show Preview
1:15 p.m. - 1:30 p.m.	Trade Show Grand Opening Ceremony
1:30 p.m. - 5:30 p.m.	Trade Show Open (with Fiesta Reception 3:00 p.m. - 5:00 p.m.)
1:30 p.m. - 5:30 p.m.	Education: AG CONNECT Main Stage on Trade Show Floor

### FRIDAY, MARCH 3

#### Optional Tours

6:45 a.m. - 6:00 p.m.	Registration Desk Open
7:00 a.m. - 8:30 a.m.	Education: Early Riser Session
9:00 a.m. - 11:00 a.m.	General Session
11:00 a.m. - 5:00 p.m.	Trade Show Open (with Lunch 11:00 a.m. - 12:30 p.m.)
12:15 p.m. - 5:00 p.m.	Education: AG CONNECT Main Stage on Trade Show Floor
12:30 p.m. - 4:00 p.m.	Education: Learning Center Sessions
12:30 p.m. - 4:10 p.m.	Education: What’s New Sessions
6:00 p.m. - 8:30 p.m.	NCGA Awards Banquet
6:00 p.m. - 9:00 p.m.	ASA Awards Banquet

### SATURDAY, MARCH 4

#### Optional Tours

7:00 a.m. - 8:00 a.m.	Education: Early Riser Sessions
7:00 a.m. - 12:30 p.m.	Registration Desk Open
8:15 a.m. - 9:15 a.m.	Education: Learning Center Sessions
8:30 a.m. - Noon	Trade Show Open (with Morning Snack 8:30 a.m. - 9:15 a.m.)
8:30 a.m. - 11:30 a.m.	Education: AG CONNECT Main Stage on Trade Show Floor
9:30 a.m. - 10:10 a.m.	Education: What’s New Sessions
5:30 p.m. - 6:00 p.m.	Worship Service
8:30 p.m. - 9:45 p.m.	Evening of Entertainment

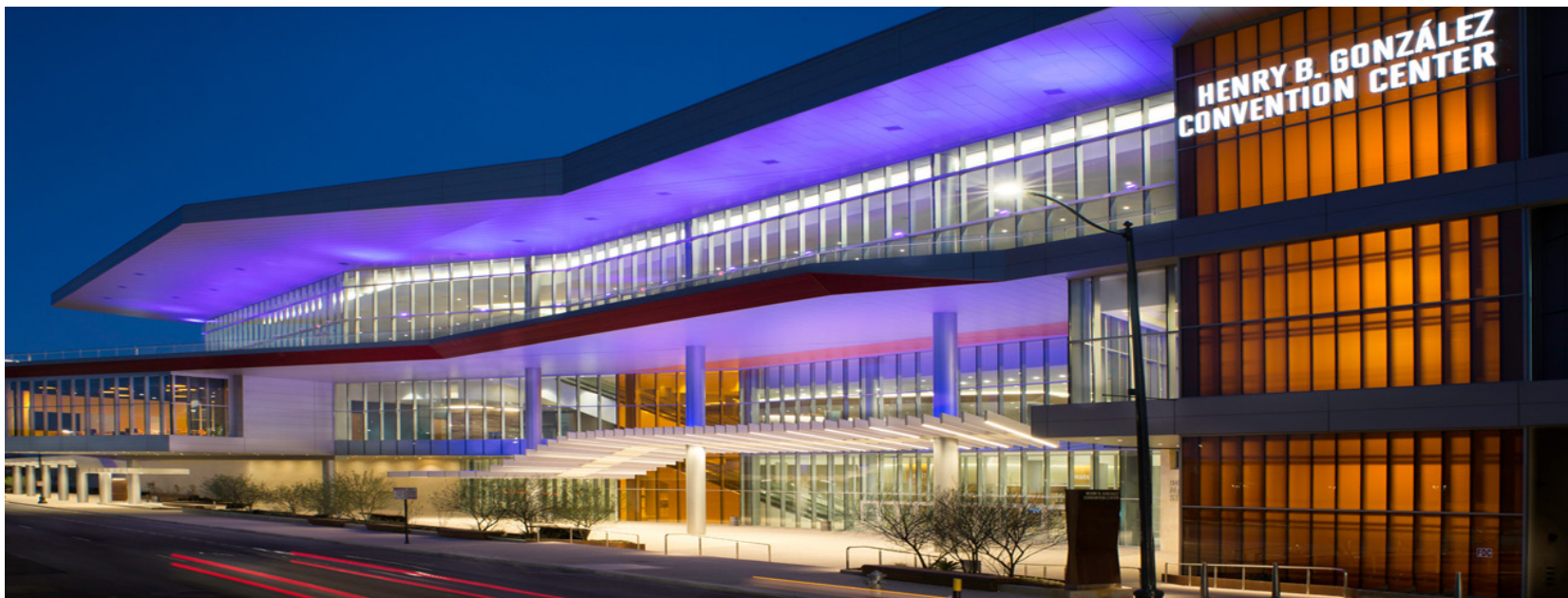

## Site of the 2017 Commodity Classic Henry B. González Convention Center 200 East Market Street

Please note: Some events may be scheduled at nearby hotels.

You can attend the General Session, Trade Show, Evening of Entertainment and any of the educational sessions and association policy meetings at no extra charge. (See page 16 for a list of everything included with your registration fee.)

### WEDNESDAY, MARCH 1

5:00 p.m. - 7:00 p.m.

(By invitation only)

#### Welcome Reception

Sponsored by Syngenta®



Syngenta is excited to be in San Antonio for the 2017 Commodity Classic. Join us for a welcome reception to kick off the week with festive food, drinks and friends.

This reception is a ticketed event for registered growers and family members, state/national commodity organization staff and media. A ticket will be included with your registration badge.

**Would you like a drink on us?** Register for the conference by January 12 to receive your complimentary drink ticket. An adult must accompany anyone under the age of 21.

See **EDUCATION AT A GLANCE**  
Schedule on page 10

### THURSDAY, MARCH 2

#### Early Riser Session

7:00 a.m. - 8:00 a.m.

#### The Great 2017 Grain Market Debate

Sponsored by Corn+Soybean Digest and Farm Futures Magazine, Penton Agriculture and Channel Seed

**Speakers:** Bryce Knorr, Senior Market Analyst, *Farm Futures*; Ed Usset, author of *Grain Marketing is Simple* and *Corn+Soybean Digest* Contributing Editor; Matt Bennett, Grain Marketing Consultant, Channel Seed



The unexpected spring rally of 2016 caught many by surprise. But growers attending last year's debate learned the conditions were forming for it. Starting work on your 2017 marketing plan could again be crucial to profitability, to figure out ways to maneuver in a market filled with uncertainty. From weather around the world to global economic developments, growers need to examine multiple scenarios that could play out in the year ahead.

#### Mini What's New Sessions

8:30 a.m. - 10:00 a.m.

During this fast-paced 90-minute window, exhibitors will provide brief, five-minute introductions to their newest innovations. Listen to their presentations and then be sure to visit these companies on the trade show floor to learn even more. Presenting companies will be listed on the Commodity Classic website in February.

#### Learning Center Session

8:30 a.m. - 10:00 a.m.

#### Break Through Yield Barriers: Production Practices for High-Yield Acres Nationwide

Sponsored by StollerUSA

**Panelists:** Dan Arkels, corn and soybean grower from Peru, Ill.; Casey Hook, cotton, soybeans, rice and corn grower from Lake City, Ark.; Zach Rendel, corn, sorghum, canola and wheat grower from Miami, Okl. **Moderators:** Ken Root, Agriculture Reporter, Dyersville, Iowa; Steven Albracht, corn, soybean and triticale grower from Hart, Texas;



(continued next page)

## Commodity Association Schedule

Schedule for business meetings, banquets and other activities involving the four commodity associations: American Soybean Association (ASA), National Corn Growers Association (NCGA), National Association of Wheat Growers (NAWG), and National Sorghum Producers (NSP).

### Wednesday, March 1

7:00 a.m. - 6:00 p.m.	NAWG Committee Meetings
8:00 a.m. - 1:00 p.m.	NSP Board of Directors Meeting
12:30 p.m. - 2:45 p.m.	NCGA Issues Briefing, Open Forum & Policy Discussion
1:00 p.m. - 5:00 p.m.	ASA Resolutions Subcommittees Meetings
2:00 p.m. - 4:30 p.m.	NSP/USCP Joint Board of Directors Meeting
3:00 p.m. - 4:30 p.m.	NCGA State Caucuses
7:00 p.m. - 9:00 p.m.	NCGA CornPAC Auction & Hors d'Oeuvres Reception

### Thursday, March 2

8:00 a.m. - 10:45 a.m.	ASA State Caucuses
8:00 a.m. - 11:30 a.m.	NCGA Corn Congress
8:00 a.m. - 12:00 p.m.	NAWG Board of Directors Meeting
9:45 a.m. - 10:00 a.m.	Sorghum Meet and Greet
10:00 a.m. - 12:30 p.m.	Sorghum General Session

### Thursday, March 2 (continued)

11:00 a.m. - 12:00 p.m.	ASA Open Policy Session
12:00 p.m. - 4:00 p.m.	National Wheat Foundation Board Meeting
6:00 p.m. - 7:00 p.m.	National Wheat Yield Contest Cocktail Reception
6:30 p.m. - 9:30 p.m.	ASA Soy Social & Auction
7:00 p.m. - 9:30 p.m.	NAWG Presidents Reception & WheatPAC Auction

### Friday, March 3

7:00 a.m. - 8:30 a.m.	National Corn Yield Contest State Award Winners Breakfast
6:00 p.m. - 8:30 p.m.	NCGA Awards Banquet
6:00 p.m. - 9:00 p.m.	ASA Awards Banquet
8:00 p.m. - 11:00 p.m.	Sorghum PAC Casino Night & Auction

### Saturday, March 4

1:00 p.m. - 4:30 p.m.	NCGA Corn Congress
1:30 p.m. - 5:30 p.m.	ASA Voting Delegates Session



Zach Rendel

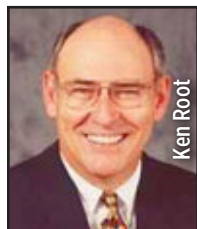

Ken Root



Steven Albracht

A diverse panel of young and seasoned growers will participate in a moderated discussion focused on management and practices used to break through yield barriers and maximize the genetic and yield potential of their crops. The discussion will focus on an

intensive, season-long approach to managing crops at each stage of the growing season. Audience members will have the opportunity to interact and participate in the discussion via real-time audience polling.

### Mini What's New Sessions

10:15 a.m. - 11:45 a.m.

Repeat of 8:30 a.m. session.

### Learning Center Session

10:15 a.m. - 11:45 a.m.

## The Ag Economy Barometer: A Look at Conditions Headed into 2017

Sponsored by Purdue University Center for Commercial Agriculture



Michael Boehlje



Jason Henderson



Dave Lehman



James Mintert



David Widmar

**Panelists:** Michael Boehlje, Ph.D., Distinguished Professor, Department of Agricultural Economics, Purdue University; Jason Henderson, Ph.D., Associate Dean and Director of Purdue Extension; Dave Lehman, Managing Director, CME Group;

James Mintert, Ph.D., Professor, Department of Agricultural Economics, and Director, Center for Commercial Agriculture, Purdue University; David Widmar, Senior Research Associate, Center for Commercial Agriculture, Purdue University

For the second consecutive year, farmers in the Midwest planted their 2016 corn, soybean, and wheat crops knowing that economic losses were all but certain. Facing lower commodity prices and stubbornly high input costs, producers have been relying on financial reserves as they wait for conditions to improve. Many producers will begin the 2017 growing season wondering and hoping conditions have improved over the previous growing season. This will be especially true as lower commodity prices have persisted. In this session, an expert panel of five agricultural economists from Purdue University and the CME Group will share the key economic and financial insights producers need to know heading into 2017.

### Trade Show Grand Opening

1:15 p.m. - 1:30 p.m.

Join us for the Grand Opening Ceremony at the entrance to Trade Show.

### Trade Show Open

1:30 p.m. - 5:30 p.m.

The trade show features leading agribusiness decision makers and showcases state-of-the-art products and technology. You will see the latest innovations firsthand. When you visit the booths, be sure to share your thoughts with industry representatives. By asking questions and offering input today, you help influence the agricultural products, policies and services of tomorrow.

### AG CONNECT Main Stage

Presented by Commodity Classic and Successful Farming®

1:30 p.m. - 5:30 p.m.

Thursday's schedule includes humorist Jolene Brown, a look at the global impact of Brazil, a panel discussion with agribusiness CEOs, marketing plan development, and the winners of the "Fight to Farmer" contest featuring farmers who have served in the military.

### Trade Show Fiesta Reception

3:00 p.m. - 5:00 p.m.

Sponsored by Commodity Classic

A ticket for this afternoon reception on the trade show floor is included in all full registration packages and Thursday one-day registration packages.

### ASA Soy Social and Auction

6:30 p.m. Dinner & Silent Auction

7:30 p.m. Live Auction Begins



Round up your fellow ASA members and get ready to "Rodeo in San Antonio" at our 12th Annual Soy Social and Auction. Event ticket required. Casual attire. For more information and to purchase tickets, please visit SoyGrowers.com.

### NAWG Presidents Reception & WheatPAC Auction

7:00 p.m. - 9:30 p.m.



Please join the National Association of Wheat Growers (NAWG) at the Hilton Palacio del Rio for an evening of honoring NAWG's outgoing and incoming Presidents. The event will be combined with the 2017 auction, and with countless great items up for auction and a buffet, you won't want to miss this! The National Wheat Foundation will also recognize the 2015-2016 winners of the National Wheat Yield Contest with a cocktail hour at 6 p.m., before the auction event at 7 p.m. Separate tickets will be required for the National Wheat Yield Contest Cocktail Reception, and we encourage you to buy before the event. For more information regarding sponsorship opportunities and tickets, please call Liz Leith at NAWG, (202) 547-7800 or finance@wheatworld.org.

## FRIDAY, MARCH 3

### Early Riser Marketing Session

7:00 a.m. - 8:30 a.m.

### U.S. Farm Report

Sponsored by Farm Journal Media



Tyne Morgan



**Moderator:** Tyne Morgan, Host of U.S. Farm Report

Be a part of "U.S. Farm Report," the nation's longest-running, syndicated, agricultural news program, produced by Farm Journal Broadcast. See a television show in the making and guide the lively discussion by asking questions of host Tyne Morgan and a panel of commodity traders and analysts. Gain insight into futures, market trends and other agricultural issues as the experts debate topics you present. Highlights from this special television taping will air nationwide on "U.S. Farm Report."

### General Session

9:00 a.m. - 11:00 a.m.

Sponsored by Dow AgroSciences



**Dow AgroSciences**



John O'Leary



Mark Mayfield

**Moderator:** Mark Mayfield

**Keynote:** John O'Leary

The General Session is where you truly experience the importance of Commodity Classic. Throughout the session, there is a strong sense of common purpose with a combination of inspiration, information and insight. Comedian Mark Mayfield returns to the stage, along with commodity organization leaders, for a discussion of the hottest issues facing our nation's corn, soybean, wheat and sorghum farmers. Additionally, there will be an update from the Association of Equipment Manufacturers. The session concludes with John O'Leary, who will powerfully reveal how our greatest challenges can be transformed into the foundation for outstanding growth. A living example of the power of the human spirit, he will explain how moving outside of your comfort zone, dreaming big and taking action can transform your life.

### Trade Show Open

11:00 a.m. - 5:00 p.m.

Be among the first to hear about game-changing ideas, new products and technology directly from the people who created them. You will see the latest innovations firsthand and talk one-on-one with top agribusiness representatives at the incredible trade show. And while you are there, be sure to enter the many drawings and giveaways being offered.

### Trade Show Lunch

11:00 a.m. - 12:30 p.m.

Sponsored by Commodity Classic

A trade show lunch ticket is included in all full registration packages and Friday one-day registration packages.

facebook.com/CommodityClassic

@ComClassic #Classic17 #FarmerUp

## AG CONNECT Main Stage

Presented by Commodity Classic and Successful Farming®

12:15 p.m. - 5:00 p.m.

Friday's schedule features the popular Hefty Brothers of Ag PhD, a discussion of drone technology, engine and equipment maintenance tips, commodity trading, and an inside look at innovative farm shops.

## What's New Sessions

12:30 p.m. - 4:10 p.m.

What's New Sessions offer exhibitors an opportunity to showcase their latest innovations and services. Attend these 40-minute presentations and ask questions of company representatives. Check the Commodity Classic website in February, your on-site program booklet and the mobile app for a list of the presenting companies and their topics.

## Learning Center Sessions

12:30 p.m. - 1:30 p.m.

### The Link Between USDA Statistics and Administration of Farm Bill Programs

Sponsored by USDA National Agricultural Statistics Service (NASS) and National Corn Growers Association (NCGA)



Lance Honig



Brad Karmen



Robert Ibarra

**Speakers:** Lance Honig, Chief of Crops Branch, USDA National Agricultural Statistics Service; Brad Karmen, Deputy Administrator for Farm Programs, USDA Farm Service Agency; Robert Ibarra, Deputy Administrator, USDA Risk Management Agency

The current Farm Bill requires greater use of the United States Department of Agriculture (USDA) statistics in the administration of producer support agencies like the Risk Management Agency (RMA) and Farm Service Agency (FSA). This session will detail the role of the National Agriculture Statistics Service (NASS) in producing official USDA statistics. The NASS will cover how official USDA statistics are prepared and disseminated. The agencies will discuss how they utilize these statistics in the administration of the Farm Bill, the challenges related to collecting data from growers and industry partners and their impact on Farm Bill programs.

**KEEP YOUR name badge when you head home!**

Your badge number is your key to access the entire library of education session videos from the 2017 Commodity Classic. Video access is FREE with full registration and at a discounted cost for a one-day registration.

### Plant Health: A Pivotal Input in a Successful Management Plan

Sponsored by BASF



Megan Andriankaja



Caren Schmidt



Robert Kemerait

**Speakers:** Megan Andriankaja, Ph.D., Technical Marketing Manager, BASF; Caren Schmidt, Ph.D., Technical Marketing Manager, BASF; Robert C. Kemerait, Jr., Ph.D., Professor and Extension Specialist, Department of Plant Pathology, University of Georgia

This session will address how growers can reduce risk on their operation and maximize yield potential with healthy plants throughout the season. By integrating plant health into their crop plans, growers can help prevent disease, and increase growth efficiency and stress tolerance in the individual plant.

Based on years of research, the presenters will outline how plant health can help growers remain successful in the face of unfavorable commodity prices or planting conditions, increased crop disease, or volatile weather during the season.

### Achieving Sustainability with a Certified Crop Adviser

Sponsored by American Society of Agronomy's International Certified Crop Adviser Program

**Speakers:** Catherine Campbell, Consultant, Field to Market: The Alliance for Sustainable Agriculture, Marker Campbell Consulting; Certified Crop Advisers (Invited)



Catherine Campbell

To meet the growing demand for sustainably produced food, buyers of commodities want to know how sustainably they are produced to support their claims. Sustainable production is related to efficiency. A Certified Crop Adviser (CCA) utilizing Field to Market's (FtM) Field Print Calculator can evaluate your farm's sustainability footprint and help you select practices that will improve it.

The International CCA program now offers the Sustainability Specialist (SSp) Certification for CCAs who focus their work in whole farm sustainable practices. Learn more about the specialty along with how to identify practices that help make your operation more sustainable.

**NEW!** The 2017 recipient of the International Certified Crop Adviser (ICCA) of the Year Award will be recognized during this session. The award celebrates outstanding individual proficiency and industry leadership.

## Learning Center Sessions

1:45 p.m. - 2:45 p.m.

### Collaboration is Key to the Future of Mississippi Watershed: Agriculture, Conservation, Transportation Working Together for America's Watershed Initiative

Sponsored by National Corn Growers Association (NCGA)

**Speaker:** Harald (Jordy) Jordahl, Director, America's Watershed Initiative



Harald Jordahl

This session hosted by the National Corn Growers Association with the America's Watershed Initiative and The Nature Conservancy will address the need and successes seen to date as a result of this strong collaboration. Partners like these organizations and many others are working together on America's

Watershed Initiative to use existing resources like labor, budgets and their public voice on these critical water management issues. America's Watershed Initiative is a collaboration among hundreds of business, government, academic and civic organizations. Collectively, they are seeking to improve the economic and environmental assets represented by the network of rivers that make up the 31-state Mississippi River Watershed.

### Taking Weed Management to the Next Level

Sponsored by Monsanto Company



Dave Opperman



Darren Brown



Boyd Carey



Bryan Young



Ryan Rubischko

**Panelists:** Dave Opperman, Monsanto Ground Breakers Field Trials Under Permit Grower; Darren Brown, Monsanto Ground Breakers Field Trials Under Permit Grower; Boyd Carey, Ph.D., Crop Protection Systems Lead, Monsanto North America; Bryan Young, Ph.D., Professor, Purdue University

**Moderator:** Ryan Rubischko, Dicamba Chemistry Manager, Monsanto North America

This Learning Center Session will feature a panel of speakers discussing weed management best practices, focused on dicamba application requirements, superiority of this system and more. Attendees will learn more about the new chemistry technologies and formulation advancements that will be available to them for 2017 (pending regulatory approvals). From this panel of technical experts and growers who have firsthand experience with the new technology system, attendees will learn how to implement proper application requirements and best practices for improved stewardship and weed resistance management.

### Mitigating Risk, Maximizing Input Efficiency and Farm Profitability, and Increasing Sustainability with Drip Irrigation Technology

Sponsored by Netafim



Kurt Grimm



Mark Eitel



Kevin Matthews



Fred Below



Willie Vogt

**Speakers:** Kurt Grimm, Grower, Hiawatha, Kan.; Mark Eitel, Grower, Dighton, Kan.; Kevin Matthews, Grower, East Bend, N.C.; Fred Below, Ph.D., Professor of Crop Physiology, University of Illinois

**Moderator:** Willie Vogt, Executive Director, Content and User Engagement, Penton Agriculture

The use of drip irrigation in row crop applications continues to increase. Not just an irrigation method, a drip system enables a high level of input management. The ability to respond to a crop's specific needs in real-time—based on both growth stage and climatic conditions with precise amounts of water, nutrients and crop protection inputs—has given growers better control. This reduces financial risk and provides a higher level of sustainability. A panel of progressive growers and a leading irrigation/crop management researcher examines the role of drip irrigation in high-yield growth strategies for maximizing profitability on today's farm.

### Learning Center Sessions

3:00 p.m. - 4:00 p.m.

### Lady Luck, is Thy Name La Niña?

Sponsored by DTN/The Progressive Farmer

**Speaker:** Bryce Anderson, Senior Agriculture Meteorologist, DTN/The Progressive Farmer



Anderson and the DTN ag weather team correctly forecasted the switch between El Niño and La Niña weather patterns in the Pacific Ocean since early winter 2016. Their thoughts on the 2017 season will be critical to growers making crop plans as well as valuable to agribusiness leaders in terms of how predicting weather patterns will influence their sales and service season. Growers may adjust crops planted and/or acreage dedicated to specific crops, as well as being better prepared to make crop sales moves early in the 2017 season after learning what is to come. The session will also feature a detailed review and forecast of prospects in South America, during the final stages of the Brazil and Argentina crop seasons.

### Preserving New Soybean Herbicide Technologies in the Fight Against Resistant Weeds

Sponsored by Syngenta



**Speakers:** Dane Bowers, Technical Product Lead - Herbicides, Syngenta; Don Porter, Technical Product Lead - Herbicides, Syngenta (Invited); Tim Hambrick, Agriculture Extension Agent, NC Cooperative Extension and 2014 Resistance Fighter of the Year; Kevin

Bradley, Weed Scientist, University of Missouri (Invited); Clint Einspahr, Grower and 2011 Northern Resistance Fighter of the Year, Arapahoe, Neb. (Invited)

Herbicide resistance is an ever-growing concern for growers. Producers who plant Roundup Ready 2 Xtend® and Enlist® soybeans in 2017 may be tempted to think that these new technologies are the silver bullets for weed management. These new products will be a great addition to the toolbox; however, growers have a lot to consider before making the switch. To help navigate those decisions, Syngenta will discuss the various new soybean technologies and their corresponding herbicides available for use in 2017 and emphasize the importance of preserving these technologies to extend their life and prolong their efficacy in the face of growing resistance management issues.

### Soil Health Farming: Optimizing the Use of Cover Crops, Conservation Tillage and Nutrient Management Approaches On-Farm for Economic Profitability, Productivity and Environmental Protection

Sponsored by Soil Health Partnership and National Corn Growers Association

**Moderator:** Dr. Nicholas Goeser, Director of The Soil Health Partnership and Director of Soil Health and Sustainability for National Corn Growers Association.



**Panelists:** Terry Wehlander, Farmer and North Dakota Corn Council Treasurer; Lee Briese, Agronomist with Centrol Ag Consulting; Dr. Abbey Wick, Extension Soil Health Specialist at North Dakota State University; Tim Koosmann, corn, soybeans, and dry edible beans grower, West Central, Minnesota; Dorian Gatchell, Owner/Ag consultant for Minnesota Agricultural Services; Jodi DeJong-Hughes, Regional Soil Educator with University of Minnesota Extension; Bryan Biegler, Grower, Soil Health Partnership farmer, Minnesota Corn Growers Association member, Soybean Growers Association member; Nick Pieske, Agronomist for Centrol Crop Consulting, Inc.; Dr. Paulo Pagliari, Extension Nutrient Management Specialist at the University of Minnesota

Incorporating management approaches on-farm that benefit soil health can be tricky – it requires practical and science-based information to make it a long-term success. In general, farmers get information from separate sources. They may hear how cover crops worked for a farmer highlighted in a magazine, or get a recommendation on fertilizer applications from their agronomist or sit through a scientific presentation on conservation tillage from a scientist or extension specialist. Rarely do they have the opportunity to hear all three perspectives on a single topic in one session. In this session, we will incorporate the different perspectives of farmers, agronomists and scientists/specialists in a panel discussion covering how to manage your soils using cover crops, conservation tillage and precision fertility.

## Our version of speed-dating

Mini What's New sessions are a fast-paced series of 5-minute presentations packed in one 90-minute period on Thursday morning. Enough to whet your appetite so you can discover more on the trade show floor.

### National Corn Growers Association Awards Banquet

Sponsored by John Deere, BASF Corporation and DuPont Pioneer

6:00 p.m. - 8:30 p.m.



Join the excitement as NCGA celebrates the winners of the ever-popular annual National Corn Yield Contest, as well as all those who helped break membership records for the organization. You'll also get an update from NCGA leadership and industry representatives. Then, sit back and enjoy the humorous, interactive entertainment of the Cowboy Hypnotist, Don Warren.

### American Soybean Association Awards Banquet

Sponsored by DuPont Pioneer, John Deere, Monsanto BioAg and United Soybean Board/Soy Checkoff

6:00 p.m. - 9:00 p.m.



This dinner is an annual event that brings together state affiliates and ASA members from across the country to recognize and celebrate the successes, accomplishments and education of the many farmer-leaders, soybean associations and industry representatives who have done outstanding work to benefit U.S. soybean farmers and the soybean industry. Awards will be presented for membership growth and association outstanding achievements, leadership building, conservation stewardship and industry accomplishments and support.

### Sorghum PAC Casino Night & Auction

Sponsored by Sorghum Partners

8:00 p.m. - 11:00 p.m.



Back by popular demand! Join National Sorghum Producers for a fun-filled evening at the annual Sorghum PAC Casino Night and Auction. The event will be held at the Marriott Rivercenter. Tickets can be purchased in advance by calling NSP at (806) 749-3478, or on site at the Sorghum PAC booth near Commodity Classic registration.

facebook.com/CommodityClassic

@ComClassic #Classic17 #FarmerUp

## SATURDAY, MARCH 4

### Early Riser Sessions

7:00 a.m. - 8:00 a.m.

### What Would Make Someone Invest in Your Farm?

Sponsored by Advance Trading Inc.

**Speaker:** Tommy Grisafi, Ag Risk Management Advisor, Advance Trading Inc.



What is needed to stay in business and pass the farm on to the next generation? This presentation will use a variety of objectives to help the grower have a better understanding of how much world events move world currencies as it relates to the farming industry. Relative to global trends in marketing, growers will learn what tomorrow's farm might look like and what tools are needed to help farms of the future thrive. In addition, attendees will gain better insight to who their customers are and what they want from growers.

### Piles to Files: Weed Through Your Paperwork

Sponsored by Commodity Classic

**Speaker:** Lori Firsdon, Owner, Forte Organizers



Paperwork grows like weeds. Conquer it by learning how to sort, categorize and file your paper piles. In this informative seminar, you will learn how to:

- Apply simple strategies to address your daily mail
- Attack your paper stacks with confidence
- Make decisions and systemize document storage
- Reduce the paper you process and keep
- Streamline your filing system and find documents fast
- Use a labeler to reduce clutter and disorganization

With all the helpful systems in place, you will see less paper clutter and locate the papers you do need faster. Don't let paper invade your day any longer!

### Learning Center Sessions

8:15 a.m. - 9:15 a.m.

### The Emerging Bioeconomy: Opportunities and Challenges in Achieving Scale

Sponsored by Corn Refiners Association

**Speakers:** Rod Snyder, President, Field to Market (Invited); Chris Riley, Director, State Government Relations, Archer Daniels Midland (Invited); and Bruce Dale, Professor and Associate Director, Office of Biobased Technologies, Michigan State University (Invited)



**Moderator:** Ben Gruitt, Director, Sustainability, Corn Refiners Association

A panel of industry experts will explain the state of the emerging bioeconomy, barriers to development and potential of the bioeconomy. Factors discussed will include the low cost of petrochemical inputs, the sustainability of the bioproduct feedstocks, and the perceived tradeoff between traditional materials and biomaterials. Following presentations by the individual panelists, the session will conclude with a moderated Q&A session between the audience and panelists.

## Salute to Women in Ag

## Saturday



8:30 a.m. - 11:30 p.m.

### AG CONNECT Main Stage

### Successful Farming

Saturday's programming on the AG CONNECT Main Stage will be of special interest to the women who are important partners in the success of their farms and families. Presentations will include:

- **Cooking Demonstration** featuring a top chef sharing great recipes.
- **Marji Guyler-Alaniz**, founder of Farmher and host of her own program on RFD-TV.
- **"Holy Crap! I Married a Farmer!"**, a humorous look at farm life presented by Jolene Brown.

**NOTE:** Also check out Saturday's Early Riser session on how to organize a home office!

### Capturing the Genetic Potential of Today's Hybrids

Sponsored by AgriGold Hybrids

**Speaker:** Randy Dowdy, Grower and NCGA Corn Yield Champion, Valdosta, Georgia.



Join Randy Dowdy, a first generation farmer from Valdosta, Georgia and learn about the keys to raising higher yields. This session will cover understanding plant physiology and components of yield, alleviating inevitable stress that a plant may face, nutrient uptake: understanding timing verses availability and stepping outside your comfort zone.

### Hot Topics from Our Nation's Capital 2017

Sponsored by John Deere

**Invited Speakers:** Senior staff from the Senate and House Agriculture Committees

**Invited Moderator:** Leading Ag Journalist

This panel of DC insiders will discuss what is certain to be a busy and important year in Washington. Who will be in charge in the 115th Congress? How soon will the Agriculture Committees begin work on the next Farm Bill? What new issues will emerge and surprise us all?

This highly ranked "hot topics" panel will cover all of the issues farmers are talking about and what decision makers are doing about them. Join us to hear about Washington policies that will affect your farming operation in 2017 and beyond!

### GMOs and Sustainability Go Hand 'n Hand

Sponsored by U.S. Farmers & Ranchers Alliance

**Speakers:** Randy Krotz, CEO, U.S. Farmers & Ranchers Alliance (USFRA); USFRA Digital Voices Council Member (Invited); USFRA Faces of Farming & Ranching (Invited); FARMLAND documentary film subject/farmer (Invited); Food company representative (Invited).



Many consumers today do not associate GMOs with being the most sustainable way to grow food. Yet this technology allows farmers to use less land per bushel, it requires less water, and it utilizes pesticides and herbicides more precisely, among many other benefits. Find out how to talk to consumers about the sustainability behind your most productive tool - GMOs.

### Trade Show Open

8:30 a.m. - Noon

Your last chance to discover what's new in agriculture and speak with the people who are making it happen. Make sure your must-see exhibitor checklist has all the boxes marked!

### Trade Show Morning Snack

Sponsored by USA Poultry & Egg Export Council and The Soy Checkoff

8:30 a.m. - 9:15 a.m.

Your trade show snack ticket is included in all full registration packages or Saturday one-day registration package.

High oleic soybeans offer farmers the opportunity to grow a healthier bottom line. It has the potential to gain back lost food industry market share for you and offers restaurants and food companies a better frying experience and consumers a better-tasting product. High oleic soybean oil for the morning snack and the cooking demonstration are funded by the soy checkoff.



## Saturday-Only Registration Available

If you can't make it during the week, come in on Saturday (at a discounted rate!) to cruise the trade show, pick up some educational sessions and enjoy the Evening of Entertainment with Pat Green!



## Cooking Demonstration

Sponsored by USA Poultry & Egg Export Council and The Soy Checkoff

8:30 a.m. - 9:30 a.m.

Join Corporate Chef Mark Patel of Simmons Prepared Foods, one of America's largest chicken producing companies, to discover how to bring the best flavors of the world to your kitchen. As a graduate of the prestigious Culinary Institute of America, Chef Mark's diverse culinary career has spanned 23 years including one-of-a-kind presentations in Singapore, Hong Kong and Dubai. His globally-inspired chicken dishes will make you feel like a world traveler even if you never leave the farm! Brought to you with support from USA Poultry & Egg Export Council, Simmons Prepared Foods and the Soy Checkoff.



## What's New Sessions

9:30 a.m. - 10:10 a.m.

What's New Sessions offer exhibitors an opportunity to showcase their latest innovations and services. Attend these 40-minute presentations and ask questions of company representatives. Check the Commodity Classic website in February, your on-site program booklet and mobile app for a list of the presenting companies and their topics.

## Worship Service

5:30 p.m. - 6:00 p.m.

Sponsored by Commodity Classic

Fellowship of Christian Farmers nondenominational service. All are welcome.

**REGISTER BY**  
**January**  
**12 & SAVE \$\$\$!**

Save up to \$50 when you take advantage of early registration.

satursday

## Evening of Entertainment with Pat Green

Sponsored by Monsanto

8:30 p.m. - 9:45 p.m.

MONSANTO



Top off a terrific week at Commodity Classic by enjoying Saturday's Evening of Entertainment, sponsored by Monsanto and featuring the country sounds of Pat Green. Visit the Monsanto booth during trade show hours for an opportunity to win front-row seats. A Texas inspiration with an outsider reputation, Grammy-nominated hit maker Pat Green rocks sold out stadiums with popular hits from his past and new favorites from *Home*, the new albums that revisits his original country roots. Since his early days in Lubbock, Green has sold more than two million albums, with hits such as "Wave on Wave," and appeared on national TV shows including *Austin City Limits*, *Jimmy Kimmel Live!* and *The Late Show with David Letterman*.



## The Trade Show at Commodity Classic



400+ Exhibitors! Expected!

### Putting the nation's top farmers and companies under one really big roof.

The trade show at Commodity Classic is one of the event's top-rated experiences—and no wonder. It's an exciting, exhilarating combination of iron, ideas and innovations.

You'll get a first-hand, hands-on look at the latest technology, equipment and advancements. This is an early adopter's paradise—a place where you can get a jump on what's new.

The world's leading agribusiness companies will be there with their top people—so you can have deep conversations about what you need from them and what they can do for your farm.

And don't miss the smaller exhibitors: That's where you could discover the emerging innovations or groundbreaking idea that could absolutely transform your operation.

The trade show floor is also home to the AG CONNECT Main Stage, presented by Commodity Classic and Successful Farming®—with a powerful line-up of educational sessions and inspiring speakers.

### WANT TO EXHIBIT?

If you have a new idea, product or technology, Commodity Classic is a great way to showcase it in front of thousands of America's best farmers. You'll also be among 160 top ag media looking for stories. Or simply attend this year to check out the show to see if it's a good fit for you.

To exhibit, call (636) 922-5551 or email: [tradeshow@CommodityClassic.com](mailto:tradeshow@CommodityClassic.com).

## Education that helps America's best farmers become even better!

The line-up of educational sessions at Commodity Classic is selected by a team of farmers just like you, so you can be assured that the content, presenters and information are relevant, current and essential to your success.

Many educational sessions are concurrent. You can walk into any session without preregistering. All you need is your name badge. If a session isn't quite what you expected, don't be afraid to excuse yourself and attend another.

- Be among the first to learn about new products, technology and innovation—well before other farmers ready about them in a farm magazine
- Talk with top management, engineers and marketing professionals from the companies with which you do business
- Get your hands on new equipment and technology in the huge trade show
- Hear from thought-provoking speakers and difference-makers in agriculture
- Learn from other farmers you meet—how they deal with challenges, what they grow and how they grow it

### Commodity Classic education includes:

**Early Riser Sessions** Set your alarm for these early morning, eye-opening presentations on market trends and ag issues. Complimentary coffee and pastries are provided.

**Learning Center Sessions** In-depth discussions of current issues and topics that have a direct impact on your farm.

**Mini What's New Sessions** Commodity Classic's version of speed-dating: Back-to-back 5-minute presentation in a fast-paced 90-minute period. Get a quick overview of key innovations and new products. Then visit the exhibitors' booths in the trade show to get details.

**What's New Sessions** Concurrent 40-minute presentations offered on Friday afternoon and Saturday morning showcasing innovations and services from leading agribusinesses. Visit the presenters' trade show exhibits to learn more.

**AG CONNECT Main Stage** Located right on the trade show floor offering a great schedule of keynote speakers, panel discussions and unique ag showcases. Presented by Commodity Classic and *Successful Farming*®.



## EDUCATION AT A GLANCE SCHEDULE

SESSION TYPE	SUBJECT/TITLE	TIME	DETAILS
<b>THURSDAY, MARCH 2</b>			
Early Riser Session	The Great 2017 Grain Marketing Debate	7:00 a.m. - 8:00 a.m.	Page 4
Mini What's New Sessions	5-Minute Innovation Presentations	8:30 a.m. - 10:00 a.m.	Page 4
Learning Center Session	Break Through Yield Barriers: Production Practices for High-Yield Acres Nationwide	8:30 a.m. - 10:00 a.m.	Page 4
Mini What's New Sessions	5-Minute Innovation Presentations	10:15 a.m. - 11:45 a.m.	Page 5
Learning Center Session	The Ag Economy Barometer: A Look at Conditions Headed into 2017	10:15 a.m. - 11:45 a.m.	Page 5
AG CONNECT Main Stage	Successful Farming Editorial Presentations	1:30 p.m. - 3:00 p.m.	Page 5
	"It's a Jungle Out There": Jolene Brown	3:15 p.m. - 4:15 p.m.	Page 5
	Agribusiness Executive Panel Discussion	4:30 p.m. - 5:30 p.m.	Page 5
<b>FRIDAY, MARCH 3</b>			
Early Riser Session	Live taping of U.S. Farm Report	7:00 a.m. - 8:30 a.m.	Page 5
General Session	Keynote Speaker: John O'Leary (and much, much more!)	9:00 a.m. - 11:00 a.m.	Page 5
AG CONNECT Main Stage	Successful Farming Editorial Presentations	12:15 p.m. - 1:45 p.m.	Page 6
	Marketing Insights: Al Kluis	2:00 p.m. - 2:45 p.m.	Page 6
	Top Farm Shops : Dave Mowitz	3:00 p.m. - 3:45 p.m.	Page 6
	Ag PhD: Darren & Brian Hefty	4:00 p.m. - 5:00 p.m.	Page 6
What's New Sessions	Eight 40-minute Concurrent Sessions	12:30 p.m. - 4:10 p.m.	Page 6
Learning Center Sessions	The Link Between USDA Statistics and Administration of Farm Bill Programs	12:30 p.m. - 1:30 p.m.	Page 6
	Plant Health: A Pivotal Input in a Successful Management Plan		Page 6
	Achieving Sustainability with a Certified Crop Adviser		Page 6
Learning Center Sessions	Collaboration is Key to the Future of Mississippi Watershed: Agriculture, Conservation, Transportation Working Together for America's Watershed Initiative	1:45 p.m. - 2:45 p.m.	Page 6
	Taking Weed Management to the Next Level		Page 6
	Mitigating Risk, Maximizing Input Efficiency and Farm Profitability, and Increasing Sustainability with Drip Irrigation Technology		Page 6
Learning Center Sessions	Lady Luck, is Thy Name La Niña?	3:00 p.m. - 4:00 p.m.	Page 7
	Preserving New Soybean Herbicide Technologies in the Fight Against Resistant Weeds		Page 7
	Soil Health Farming: Optimizing the Use of Cover Crops, Conservation Tillage and Nutrient Management Approaches On-farm for Economic Profitability, Productivity & Environmental Protection		Page 7
<b>SATURDAY, MARCH 4</b>			
Early Riser Sessions	What Would Make Someone Invest in Your Farm?	7:00 a.m. - 8:00 a.m.	Page 8
	Piles to Files: Weed Through Your Paperwork	7:00 a.m. - 8:00 a.m.	Page 8
Learning Center Sessions	The Emerging Bioeconomy: Opportunities and Challenges in Achieving Scale	8:15 a.m. - 9:15 a.m.	Page 8
	Capturing the Genetic Potential of Today's Hybrids		Page 8
	Hot Topics from Our Nation's Capital		Page 8
	GMOs and Sustainability Go Hand 'n Hand		Page 8
AG CONNECT Main Stage	Cooking Demonstration	8:30 a.m. - 9:30 a.m.	Page 9
	FarmHer: Marji Guyler-Alaniz	9:45 a.m. - 10:15 a.m.	Page 8
	"Holy Crap! I Married A Farmer!": Jolene Brown	10:30 a.m. - 11:30 a.m.	Page 8
What's New Sessions	Two 40-minute Concurrent Sessions	9:30 a.m. - 10:10 a.m.	Page 9

# Helpful TRAVEL & General INFO

## LOCATION

The 22nd annual Commodity Classic will take place at the newly renovated:

**Henry B. González Convention Center**  
200 East Market Street  
San Antonio, TX 78205

Please note: Some ancillary events may be scheduled at nearby hotels.

## ABOUT SAN ANTONIO

Centrally located in the heart of Texas, San Antonio offers a blend of charm, vibrancy, and hospitality. As exciting as a major city, but as intimate as a small town, San Antonio has it all: cuisine, golf, history, architecture, vibrant arts and culture, museums and theme parks, just to name a few of its many charms. This is where Tex-Mex meets Old West. So round up the gang and come savor San Antonio!

### Travel Information

Travel Leaders is the official travel agency of Commodity Classic. They are available to assist with your air transportation and car rental needs. Please call Travel Leaders at:

(800) 245-0707  
Monday through Friday  
9:00 a.m. to 5:30 p.m. (Central Time)  
Email: [christy@travellleaders.com](mailto:christy@travellleaders.com)

After-hours emergency contact information will be provided after tickets have been issued. A transaction fee will apply: \$22 per ticket or \$30 for a family with the same last name (maximum 4 people) traveling together on the same itinerary.

### Air Transportation

The San Antonio International Airport (SAT) is located approximately 15 minutes from most Commodity Classic hotels. San Antonio International Airport offers flights from most major airlines. Travel Leaders has access to discounts on several airlines on behalf of Commodity Classic attendees. Contact Travel Leaders for details.

## GROUND TRANSPORTATION

**Airport Shuttle:** Several airport shuttles serve the San Antonio Airport and provide shared rides to the Commodity Classic hotels. Check online or inquire in baggage claim area upon arrival.

**Taxi:** Fares from the airport to San Antonio downtown areas are approximately \$25 to \$30 per taxicab. For travel within the downtown area, there is a minimum charge of \$5. Travel with a friend: up to six passengers may share a cab for the price of one.

**Ride Share:** San Antonio offers ride share services from Über and Lyft. Travelers arriving at San Antonio International Airport should meet their driver outside of Terminal B on the lower level near baggage claim.

**Rental Car:** There are several companies to choose from when renting a car at San Antonio International Airport. Car rental counters are located in Terminal A. Travel Leaders is available to assist with discounts and reservation assistance.

**Getting Around Town:** You'll find San Antonio to be a very walkable city. The River Walk's cobblestone paths, located just steps from the Convention Center and one level below the busy city above, wind gently through the city center, offering scenic pathways and waterways leading to restaurants, shops, and cultural and historic sites.

If you'd rather ride than walk, you'll find several unique, fun options for getting around downtown San Antonio. The River Taxi stops at various locations on the River Walk. One-way, one-day, and multiple-day passes are offered. The historic Streetcars, the Sightseer Special (Bus 7), and the B-Cycle Bike Share System are available to explore the downtown streets. See the Commodity Classic website under San Antonio for additional information.

### Hotel Shuttles

Commodity Classic will run complimentary hotel shuttle transportation between the Convention Center and many Commodity Classic hotels. Check out the Housing Information on pages 12-13 for more details.

## Tours

Commodity Classic has arranged for several tours of unique destinations in San Antonio and surrounding areas. Be sure to check out these optional tours on pages 14-15 as you plan your schedule. All tours are an additional fee and are not included with Commodity Classic registration fees. Transportation is included when you register for select tours. Walking tours of San Antonio do not include any transportation.

## Weather

With 300 days of sunshine a year, San Antonio is an ideal destination year-round. Temperatures in late February/early March are typically in the 50s and 60s.

## Commodity Classic Registration Desk

The Commodity Classic Registration Desk will be located in the West Registration Lobby of the Henry B. González Convention Center. Stop by the Commodity Classic registration area starting Wednesday, March 1, to pick up your registration packet and event program. If you have any questions, the registration staff will be happy to assist.

## Child Care Service

Please check with your hotel for local companies that provide in-room child care services.

### New in 2017! Kids Corner

New this year is a special place especially for the youngest Commodity Classic attendees. A parent and child resting area with activities and entertainment will be available in the Trade Show during show hours. An adult must accompany a child at all times.

## Help us *Set the Table*™ with this year's charity partner!

Commodity Classic is teaming up with Feeding America as this year's charity partner. Feeding America works with U.S. food banks to distribute food to more than 60,000 food pantries. America's family farmers produce grains and oilseeds that help provide an abundant and reliable food supply for our nation and the world. Help us reach our goal and together we can *Set the Table*™ for a hunger-free America. You can donate online at [CommodityClassic.com](http://CommodityClassic.com) or make a contribution on-site in San Antonio.



# HOTEL ACCOMMODATIONS

The 22nd annual Commodity Classic will be held at the Henry B. González Convention Center in San Antonio. Make your reservations at [CommodityClassic.com](http://CommodityClassic.com).

## Support Commodity Classic and Win!

**Win a two-night stay at next year's Commodity Classic!**  
You could win a two-night stay at one of the Commodity Classic hotels in Anaheim, site of the 2018 Commodity Classic, and a gift inspired by the exciting Anaheim location.

### The one and only way to win:

Reserve your hotel room through Experient, Commodity Classic's official housing bureau, and your name will be entered into the drawing. One winner will be drawn on Thursday, March 2, just before the Grand Opening of the Trade Show.

### Booking your hotel through Commodity Classic is the smart thing to do!

- You receive discounted hotel rates negotiated exclusively for Commodity Classic attendees
- You keep the cost of registration affordable; Commodity Classic guarantees the number of room reservations in order to negotiate and reduce the costs of events for attendees
- You reduce the risk of financial penalties to the presenting commodity associations



Experient is the official housing services company for Commodity Classic. If any company other than Experient contacts you regarding your hotel accommodations, please inform show management immediately by email: [ShowDirector@CommodityClassic.com](mailto:ShowDirector@CommodityClassic.com).

### Reservations

The hotel reservation process is managed by the Commodity Classic housing services company, Experient. Reserve your hotel room through Experient at [CommodityClassic.com](http://CommodityClassic.com). Online reservations allow you to see up-to-the-minute hotel availability.

Housing availability is on a first-come, first-serve basis. Hotel group rates are guaranteed through February 8. Reservations received after February 8 will be accepted on a space-available basis and may be at the hotel's prevailing rate. Use your Commodity Classic Housing Bureau (Experient) confirmation upon check-in. Hotels will not send confirmations.

A valid credit card is required to complete your reservation. If you cancel after the cancellation deadline or if you fail to show up on your expected arrival date, your card will be charged one night's room and tax.

### Changes, Cancellations and Cutoff Date

**January 12:** Hotel rooms canceled after this date will be charged one night's room and tax

**February 8:** Hotel group rates guaranteed through this day

**February 8:** Reservations after this day based on availability and may be at hotel's prevailing rate

All hotel changes and cancellations must be made through the housing bureau until February 8.

**After February 13:** Hotel changes and cancellations must be made directly with the hotel

Please note that transferring the reservation information from the housing bureau to the hotel system will take a few days and will be available after February 13. Rest assured, the hotel will honor the booking with a confirmation number from Experient.

### Cancellation Policy

- Rooms must be canceled by January 12 to avoid a charge of one night's room and tax.
- Guests must inform the hotel front desk upon arrival if departure date has changed to avoid possible early departure fee.

# OFFICIAL HOTELS



#	Hotel	Rates**	Amenities***
1	<b>Courtyard San Antonio Riverwalk</b> 207 N. St. Mary's Street 0.7 miles to Convention Center* 100% smoke free	\$175 Single/Double/Triple/Quad	<ul style="list-style-type: none"> <li>Parking: Valet-Parking \$31/overnight with in/out privileges</li> <li>Internet: Complimentary wireless in guest room &amp; public area</li> <li>Business Center</li> <li>Outdoor Pool</li> <li>Fitness Center</li> <li>Restaurant on property</li> <li>Refrigerator &amp; Microwave in guest room</li> </ul>
2	<b>Crockett Hotel</b> 320 Bonham Street 0.6 miles to Convention Center* 100% smoke free	\$145 Single/Double/Triple/Quad <i>Children under 18 stay free with an adult.</i>	<ul style="list-style-type: none"> <li>Parking: Valet-Parking \$24/overnight with in/out privileges</li> <li>Internet: Complimentary wireless in guest room &amp; public area</li> <li>Business Center</li> <li>Outdoor Pool</li> <li>Fitness Center</li> <li>Spa Services</li> <li>Complimentary breakfast</li> <li>Avis Car Rental is adjacent to property</li> </ul>
3	<b>Drury Inn &amp; Suites San Antonio Riverwalk</b> 201 N. St. Mary's Street 0.7 miles to Convention Center* 100% smoke free	\$150 Single/Double/Triple/Quad <i>Children under 18 stay free with an adult.</i>	<ul style="list-style-type: none"> <li>Parking: Self-Parking \$16/overnight with in/out privileges</li> <li>Internet: Complimentary wireless in guest rooms &amp; public area</li> <li>Business Center</li> <li>Outdoor Pool</li> <li>Fitness Center</li> <li>Complimentary breakfast and evening reception</li> <li>Refrigerator &amp; Microwave in guest room</li> </ul>
4	<b>Drury Plaza Hotel San Antonio Riverwalk</b> 105 S. St. Mary's Street 0.6 miles to Convention Center* 100% smoke free	\$150 Single/Double/Triple/Quad <i>Children under 18 stay free with an adult.</i>	<ul style="list-style-type: none"> <li>Parking: Valet-Parking \$21/overnight with in/out privileges</li> <li>Internet: Complimentary wireless in guest rooms &amp; public area</li> <li>Business Center</li> <li>Outdoor &amp; Indoor Pool</li> <li>Fitness Center</li> <li>Complimentary breakfast and evening reception</li> <li>Refrigerator &amp; Microwave in guest room</li> </ul>
5	<b>The Emily Morgan San Antonio</b> 705 E. Houston Street 0.6 miles to Convention Center* 100% smoke free	\$189 Single/Double/Triple/Quad	<ul style="list-style-type: none"> <li>Parking: Valet-Parking \$35/overnight with in/out privileges</li> <li>Internet: Complimentary wireless in guest rooms &amp; public area</li> <li>Business Center</li> <li>Outdoor Pool</li> <li>Fitness Center</li> <li>Restaurant on property</li> </ul>
6	<b>Fairfield Inn &amp; Suites San Antonio Downtown/Alamo Plaza</b> 422 Bonham Street 0.7 miles to Convention Center* 100% smoke free	\$129 Single/Double/Triple/Quad <i>Children under 18 stay free with an adult.</i>	<ul style="list-style-type: none"> <li>Parking: Valet-Parking \$23/overnight with in/out privileges</li> <li>Internet: Complimentary wireless in guest rooms &amp; public areas</li> <li>Business Center</li> <li>Outdoor Pool</li> <li>Fitness Center</li> <li>Complimentary breakfast</li> </ul>
7	<b>Grand Hyatt San Antonio</b> 600 E. Market Street Adjacent to Convention Center* 100% smoke free	\$209 Single/Double \$235 Triple/Quad <i>Children under 18 stay free with an adult.</i>	<ul style="list-style-type: none"> <li>Parking: Valet-Parking \$39/overnight; Self-Parking \$29/overnight; with in/out privileges for both</li> <li>Internet: Complimentary wireless in guest room &amp; public areas</li> <li>Business Center/ FedEx</li> <li>Outdoor Pool</li> <li>Fitness Center</li> <li>Restaurant on property</li> <li>Refrigerator in guest room</li> <li>Enterprise Rent-A-Car on property</li> </ul>
8	<b>Hampton Inn San Antonio Downtown (Riverwalk)</b> 414 Bowie Street 0.5 miles to Convention Center* 100% smoke free	\$155 Single/Double/Triple/Quad <i>Children under 18 stay free with an adult.</i>	<ul style="list-style-type: none"> <li>Parking: Self-Parking \$15/overnight with in/out privileges</li> <li>Internet: Complimentary wireless in guest rooms &amp; public area</li> <li>Business Center</li> <li>Outdoor Pool</li> <li>Fitness Center</li> <li>Complimentary breakfast</li> </ul>

OFFICIAL HOTELS (CONTINUED)

#	Hotel	Rates**	Amenities***
9	<b>Hilton Palacio del Rio</b> 200 S. Alamo Street 0.4 miles to Convention Center* 100% smoke free	\$199 Single/Double \$224 Triple \$249 Quad <i>Children under 18 stay free with an adult.</i>	<ul style="list-style-type: none"> <li>• Parking: Valet-Parking \$42/overnight; Self-Parking \$29/overnight; with in/out privileges for both</li> <li>• Internet: Complimentary wireless in guest rooms &amp; public area</li> <li>• Business Center</li> <li>• Fitness Center</li> <li>• Restaurant on property</li> <li>• Refrigerator in guest room</li> </ul>
10	<b>Holiday Inn San Antonio River Walk</b> 217 N. St. Mary's Street 0.7 miles to Convention Center* 100% smoke free	\$169 Single/Double/Triple/Quad <i>Children under 18 stay free with an adult.</i>	<ul style="list-style-type: none"> <li>• Parking: Valet-Parking \$30/overnight; Self-Parking \$25/overnight with in/out privileges for both</li> <li>• Internet: Complimentary wireless in guest rooms &amp; public area</li> <li>• Business Center</li> <li>• Outdoor Pool</li> <li>• Fitness Center</li> <li>• Restaurant on property</li> <li>• Refrigerator in guest room</li> </ul>
11	<b>Hotel Valencia Riverwalk</b> 150 E. Houston Street 0.7 miles to Convention Center* 100% smoke free	\$169 Single/Double/Triple/Quad <i>Children under 18 stay free with an adult.</i>	<ul style="list-style-type: none"> <li>• Parking: Valet-Parking: \$34/overnight with in/out privileges; Daily valet \$15/day</li> <li>• Internet: Complimentary wireless in guest rooms &amp; public areas</li> <li>• Business Center</li> <li>• Fitness Center</li> <li>• Restaurant on property</li> </ul>
12	<b>Hyatt Place San Antonio/Riverwalk</b> 601 S. St. Mary's Street 0.5 miles to Convention Center* 100% smoke free	\$196 Single/Double/Triple/Quad <i>Children under 18 stay free with an adult.</i>	<ul style="list-style-type: none"> <li>• Parking: Complimentary Self-Parking</li> <li>• Internet: Complimentary wireless in guest room &amp; public area</li> <li>• Business Center</li> <li>• Outdoor Pool</li> <li>• Fitness Center</li> <li>• Restaurant on property</li> <li>• Complimentary breakfast</li> <li>• Refrigerator in guest room</li> </ul>
13	<b>Hyatt Regency San Antonio Riverwalk</b> 123 Losoya Street 0.5 miles to Convention Center* 100% smoke free	\$194 Single/Double/Triple/Quad <i>Children under 18 stay free with an adult.</i>	<ul style="list-style-type: none"> <li>• Parking: Valet-Parking \$39/overnight; Self-Parking \$29/overnight with in/out privileges for both</li> <li>• Internet: Complimentary wireless in guest room &amp; public areas</li> <li>• Business Center</li> <li>• Outdoor Pool</li> <li>• Fitness Center – additional charge</li> <li>• Restaurant on property</li> <li>• Refrigerator in guest room</li> </ul>
14	<b>La Quinta Inns &amp; Suites San Antonio Riverwalk</b> 303 Blum Street 0.3 miles to Convention Center* 100% smoke free	\$151 Single/Double/Triple/Quad <i>Children under 18 stay free with an adult.</i>	<ul style="list-style-type: none"> <li>• Parking: Valet-Parking \$25/overnight; Self-Parking \$21/overnight with in/out privileges for both</li> <li>• Internet: Complimentary wireless in guest room &amp; public area</li> <li>• Business Center</li> <li>• Outdoor Pool</li> <li>• Fitness Center</li> <li>• Complimentary breakfast</li> <li>• Refrigerator &amp; Microwave in guest room</li> </ul>
15	<b>Marriott Plaza San Antonio</b> 555 S. Alamo Street 0.4 miles to Convention Center* 100% smoke free	\$189 Single/Double/Triple/Quad	<ul style="list-style-type: none"> <li>• Parking: Valet-Parking \$30/overnight; Self-Parking \$25/overnight with in/out privileges for both</li> <li>• Internet: Complimentary wireless in guest room &amp; public area</li> <li>• Business Center</li> <li>• Outdoor Pool</li> <li>• Fitness Center</li> <li>• Restaurant on property</li> <li>• Refrigerator &amp; Microwave in guest room</li> </ul>
16	<b>Menger Hotel</b> 204 Alamo Plaza 0.4 miles to Convention Center* 100% smoke free	\$145 Single/Double/Triple/Quad <i>Children under 18 stay free with an adult.</i>	<ul style="list-style-type: none"> <li>• Parking: Valet-Parking \$25/overnight with in/out privileges</li> <li>• Internet: Complimentary wireless in guest room &amp; public area</li> <li>• Business Center</li> <li>• Fitness Center</li> <li>• Spa Services</li> <li>• Restaurant on property</li> <li>• Refrigerator in guest room</li> </ul>
17	<b>Omni La Mansion del Rio</b> 112 College Street 0.7 miles to Convention Center* 100% smoke free	\$229 Single/Double/Triple/Quad <i>Children under 18 stay free with an adult.</i>	<ul style="list-style-type: none"> <li>• Parking: Valet-Parking \$35/overnight with in/out privileges.</li> <li>• Internet: Complimentary wireless in guest room &amp; public area</li> <li>• Business Center</li> <li>• Outdoor Pool</li> <li>• Fitness Center</li> <li>• Spa Services</li> <li>• Restaurant on property</li> </ul>
18	<b>Residence Inn San Antonio Downtown/Alamo Plaza</b> 425 Bonham Street 0.6 miles to Convention Center* 100% smoke free	\$175 Single/Double/Triple/Quad <i>Children under 18 stay free with an adult.</i>	<ul style="list-style-type: none"> <li>• Parking: Self and Valet-Parking \$24/overnight with in/out privileges for both</li> <li>• Internet: Complimentary wireless in guest room &amp; public area</li> <li>• Business Center</li> <li>• Outdoor Pool</li> <li>• Fitness Center</li> <li>• Complimentary Breakfast daily and Evening Reception (Monday-Wednesday)</li> <li>• Refrigerator &amp; Microwave in guest room</li> </ul>
19	<b>San Antonio Marriott Rivercenter</b> 101 Bowie Street 0.3 miles to Convention Center* 100% smoke free	\$209 Single/Double \$229 Triple \$249 Quad <i>Children under 18 stay free with an adult.</i>	<ul style="list-style-type: none"> <li>• Parking: Valet-Parking \$41/overnight with in/out privileges</li> <li>• Internet: 50% discount in guest rooms; Complimentary wireless in public areas</li> <li>• Business Center/ UPS</li> <li>• Indoor and Outdoor Pool</li> <li>• Fitness Center</li> <li>• Restaurant on property</li> <li>• Refrigerator in guest room</li> <li>• Hertz Rental Car on property</li> </ul>
20	<b>San Antonio Marriott Riverwalk</b> 899 E. Market Street Across the street from the Convention Center* 100% smoke free	\$209 Single/Double \$229 Triple \$249 Quad <i>Children under 18 stay free with an adult.</i>	<ul style="list-style-type: none"> <li>• Parking: Valet-Parking \$41/overnight with in/out privileges</li> <li>• Internet: 50% discount in guest rooms; Complimentary wireless in public areas</li> <li>• Business Center/ UPS</li> <li>• Indoor and Outdoor Pool</li> <li>• Fitness Center</li> <li>• Restaurant on property</li> <li>• Refrigerator in guest room</li> <li>• Hertz Rental Car located in San Antonio Marriott Rivercenter</li> </ul>
21	<b>SpringHill Suites San Antonio Downtown/ Alamo Plaza</b> 411 Bowie Street 0.5 miles to Convention Center* 100% smoke free	\$129 Single/Double/Triple/Quad <i>Children under 18 stay free with an adult.</i>	<ul style="list-style-type: none"> <li>• Parking: Valet-Parking \$23/overnight with in/out privileges</li> <li>• Internet: Complimentary wireless in guest room &amp; public area</li> <li>• Business Center</li> <li>• Outdoor Pool</li> <li>• Fitness Center</li> <li>• Refrigerator &amp; microwave in guest room</li> <li>• Complimentary breakfast</li> </ul>
22	<b>The Westin Riverwalk San Antonio</b> 420 W. Market Street 0.6 miles to Convention Center* 100% smoke free	\$199 Single/Double/Triple/Quad (City View) \$229 Single/Double/Triple/Quad (River View) <i>Children under 18 stay free with an adult.</i>	<ul style="list-style-type: none"> <li>• Parking: Valet-Parking \$42/overnight with in/out privileges;</li> <li>• Self-Parking \$18/overnight does not include in/out privileges</li> <li>• Internet: Complimentary wireless in guest room &amp; public area</li> <li>• Business Center</li> <li>• Outdoor Pool</li> <li>• Fitness Center</li> <li>• Spa Services</li> <li>• Refrigerator in guest room</li> <li>• Restaurant on property</li> </ul>
23	<b>Wyndham San Antonio Riverwalk</b> 111 E. Pecan Street 0.9 miles to Convention Center* 100% smoke free	\$179 Single/Double/Triple/Quad <i>Children under 18 stay free with an adult.</i>	<ul style="list-style-type: none"> <li>• Parking: Valet-Parking \$25/overnight; Self-Parking \$23.74/overnight with in/out privileges for both</li> <li>• Internet: Complimentary wireless in guest room &amp; public area</li> <li>• Business Center</li> <li>• Outdoor Pool</li> <li>• Fitness Center</li> <li>• Spa Services</li> <li>• Restaurant on property</li> </ul>

HOTEL ACCOMMODATIONS (CONT.)

Questions?

(800) 465-0482  
 Experient Office Hours: 9 a.m. - 6 p.m.  
 Eastern Time, Monday-Friday  
 Email: [attende@CommodityClassic.com](mailto:attende@CommodityClassic.com)  
 Reservations cannot be accepted by phone or email.  
 Rates do not include tax. Amenities and fees are subject to change.

Convention Shuttles

Sponsored by NACHURS and Commodity Classic

Complimentary convention shuttle transportation will be provided between the Henry B. González Convention Center and the following Commodity Classic hotels:

- Courtyard San Antonio Riverwalk
- Drury Inn & Suites San Antonio Riverwalk
- Drury Plaza Hotel San Antonio Riverwalk
- The Emily Morgan San Antonio
- Fairfield Inn & Suites San Antonio Downtown/Alamo Plaza
- Hampton Inn San Antonio Downtown (Riverwalk)
- Holiday Inn San Antonio Riverwalk
- Hotel Valencia Riverwalk
- Hyatt Place San Antonio/Riverwalk
- Hyatt Regency San Antonio Riverwalk
- Marriott Plaza San Antonio
- Omni La Mansion del Rio
- Residence Inn San Antonio Downtown/Alamo Plaza
- SpringHill Suites San Antonio Downtown/Alamo Plaza
- Westin Riverwalk San Antonio
- Wyndham San Antonio Riverwalk

Hotels not listed above will not be offering shuttle service.

 [facebook.com/CommodityClassic](https://www.facebook.com/CommodityClassic)

 @ComClassic  
#Classic17  
#FarmerUp



**\*HOTEL DISTANCE:** Distance shown is to the Henry B. Gonzalez Convention Center and to the Commodity Classic Registration Desk. The Registration Desk is located outside of Hall 4 in the West Registration Lobby within the Convention Center.

**\*\*RATES:** Rates do not include tax.

**\*\*\*AMENITIES:** Hotel amenities and hotel amenities' prices are subject to change. Rates do not include tax.

CONVENTION CENTER:

Henry B. González Convention Center  
 200 East Market Street  
 San Antonio, TX 78205

Commodity Classic has arranged optional tours to help you experience San Antonio to the fullest! Check out the tour schedule below and visit [CommodityClassic.com](http://CommodityClassic.com) for more details about each tour and to make reservations.

## WEDNESDAY, MARCH 1

Toyota Manufacturing Plant	8:00 a.m. - 11:30 a.m.
Welcome to Our City! Tour	8:00 a.m. - 12:00 p.m.
LBJ Ranch and Sauer-Beckmann Farm	8:00 a.m. - 4:30 p.m.
Klepac Greenhouses & Garrison Brothers Distillery	8:30 a.m. - 4:30 p.m.
Cruising Through History	12:00 p.m. - 4:00 p.m.
Ranger Creek Distillery	1:00 p.m. - 4:00 p.m.

## THURSDAY, MARCH 2

Toyota Manufacturing Plant	8:00 a.m. - 11:30 a.m.
Welcome to Our City! Tour	8:00 a.m. - 12:00 p.m.
San Antonio Zoo	10:00 a.m. - 2:00 p.m.

## FRIDAY, MARCH 3

DoSeum Children's Museum	12:00 p.m. - 4:00 p.m.
--------------------------	------------------------

## SATURDAY, MARCH 4

Ranger Creek Distillery	1:00 p.m. - 4:30 p.m.
Architectural Splendors of San Antonio's Past	1:00 p.m. - 5:00 p.m.
Cruising Through History	1:00 p.m. - 5:00 p.m.
Natural Bridge Caverns	1:00 p.m. - 5:00 p.m.
Rafting on the Guadalupe River	1:00 p.m. - 5:00 p.m.
San Antonio Missions	1:00 p.m. - 5:00 p.m.
Sandy Oaks Olive Orchard	1:00 p.m. - 5:00 p.m.

**TOUR REGISTRATION INFORMATION** Please visit [CommodityClassic.com](http://CommodityClassic.com) to register for tours. Tours may be reserved online, by mail, or via fax using the provided form on the Commodity Classic website.

Capers DMC is the official tour company of Commodity Classic. Tours are not included with convention registration. Tour prices include all local taxes. Reservations are confirmed on a first-come, space-available basis. All tours include transportation unless stated otherwise.

**Deadline to preregister for tours is February 8, 2017.**

On-site registration will be accommodated subject to space availability. Tour registrations are refundable only if cancelled by February 8.

Capers DMC reserves the right to cancel any tour if the required minimum number of participants is not met by February 8.

Refunds for any tour cancelled by Capers DMC will be mailed to registrants without penalty. For questions pertaining to tours, please contact Capers at (210) 226-6652 Monday-Friday, 9:00 a.m.- 5:00 p.m., or email [darlene@capersdmc.com](mailto:darlene@capersdmc.com).

Tours may not be reserved by telephone. All tours depart from the Grand Hyatt Hotel, Market Street Doors.

## WEDNESDAY, MARCH 1

### Toyota Manufacturing Plant

Wednesday, March 1  
8:00 a.m. - 11:30 a.m.

**\$37.00**

San Antonio is home to the 2.2 million square foot Toyota Tundra Manufacturing Plant. Join us for a tour and see just what goes into the manufacturing of the Toyota Tundra as it rolls off the assembly line each day.



Explore areas of the state-of-the-art facility that includes the body weld shop, where stamped steel pieces are welded together using computer-controlled robots. The result is the truck's completed body shell. Next, the tour visits the plastics shop where critical components are made including the vehicle bumpers and instrument panels. Overhead, you will see conveyors transporting the trucks to the final assembly line. Note: closed shoes and long pants are required on this tour. Guests must be older than 6 years of age.

### Welcome to Our City! Tour

Wednesday, March 1  
8:00 a.m. - 12:00 p.m.

**\$44.00**

San Antonio is a city spilling over with culture, history, politics, style and youthfulness making it a unique and charming destination. This driving tour includes a visit to the Mexican Market where you will get as close to real Mexico as possible this side of the border! The tour will visit key landmarks in downtown San Antonio including the Spanish Governor's Palace, Main Plaza,

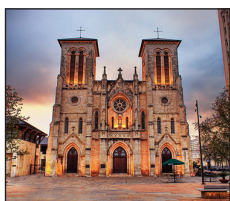

San Fernando de Bexar Cathedral, Hemisfair Park and La Villita. Then it will travel on to the King William Historic District where prosperous German merchants built their grand homes. We will stop at Guenther House and tour the delightful gift shop filled with treats for those who love to cook - or eat. Guests will enjoy a pastry from this legendary bakery. The final stop on the tour is to The Alamo, the first San Antonio mission.

### LBJ Ranch and Sauer-Beckmann Farm

Wednesday, March 1  
8:00 a.m. - 4:30 p.m.

**\$77.00**

Explore the scenic backroads of the Texas Hill Country and learn about Texas cowboys and the Great Trail Texas cattle drives. Our first stop is the Lyndon B. Johnson (LBJ) State Park and Historic Site, once known as the "Texas White House" and home to LBJ and his wife Lady Bird. Next, the tour will visit the Sauer-Beckmann Farm. It is a living-history farmstead which recreates rural farm life from 1900-1918. From there, the tour will travel to the historic town of Fredericksburg for lunch on your own in one of the charming cafes or at an authentic German biergarten. Fredericksburg is also home to the National Museum of the Pacific War. On our way back, the tour will stop in Luckenbach. Willie Nelson made the storied musical history of the town world-famous!



## Klepac Greenhouses & Garrison Brothers Distillery

Wednesday, March 1  
8:30 a.m. - 4:30 p.m.

**\$99.00, with lunch**

Today's tours take us to three Texas Hill Country family-owned and operated operations. Klepac Greenhouses opened its doors in 1955 and the third generation is currently involved in the operations. Their plants are grown and nurtured in the cool hills of the picturesque region with clear water from the pristine Blanco River Valley then handpicked and shipped fresh daily all across Texas.



Then we will tour and lunch at Compass Rose Cellars, a small boutique winery. Their wines are unique because they contain only Texas fruit. The owner will lead the tour and is excited to share his experiences. Following lunch, we will visit the Garrison Brothers Distillery. The Distillery grows winter wheat on their ranch that becomes the base of their mash. They source yellow corn from the Texas Panhandle and two-row barley from the Pacific Northwest and Canada.

## Cruising Through History

Wednesday, March 1  
12:00 p.m. - 4:00 p.m.

**\$35.00**

Cruise through one of the world's most unique waterways, on the Paseo del Rio, or San Antonio Riverwalk. It symbolizes the heart and soul of the city. We will travel to the historic Plazas of La Villita, a collection of buildings that date to the mid-1800s where we will board our privately chartered river barge cruiser. The first stop will be Main Plaza, for a tour of the San Fernando de Bexar Cathedral. Then it is off to the Southwest School of Art, once home to the cloistered order of the Ursuline sisters. We then cruise through the South Bank, to the Paseo del Alamo, an architectural interesting path from the river, known as the lifeblood to the Alamo. The tour will end at The Alamo, the first San Antonio mission.



## Ranger Creek Distillery

Wednesday, March 1  
1:00 p.m. - 4:00 p.m.

**\$65.00**

As the only "brewstillery" in Texas, they offer a unique, educational tour where you can learn how they make their beer and bourbon. This fun and informative tour is actually two tours in one! You will learn how they make beer and bourbon; and at the end, you will understand the fascinating relationship between the two products. This intimate, immersive experience focuses on education but ensures you have a drink in your hand while you are learning. This full tour includes a detailed guided tour, a souvenir pint glass, and three samples of their products. It is educational and fun! Ages 21 and up.



## THURSDAY, MARCH 2

### Toyota Manufacturing Plant

Thursday, March 2  
8:00 a.m. - 11:30 a.m.

**\$37.00**

*Repeat, see Wednesday description*

### Welcome to Our City! Tour

Thursday, March 2  
8:00 a.m. - 12:00 p.m.

**\$44.00**

*Repeat, see Wednesday description*

## San Antonio Zoo

Thursday, March 2: 10:00 a.m. - 2:00 p.m.

\$44.00

Lions and Tigers and Bears – Oh My! Explore and learn in one of the country's top zoological parks! The San Antonio Zoo has a collection of over 3,500 animals: everything from antelopes to zebras. Over 1 million visitors each year make this a part of their San Antonio experience! Highlights include "Africa Live!" exhibit, a replication of the wilds of Africa where you can watch the hippos and crocodiles. The new "Giraffes in the Savannah" exhibit allows you to look eye-to-eye with the world's tallest land mammal.



## FRIDAY, MARCH 3

### DoSeum – Children's Museum

Friday, March 3: 12:00 p.m. - 4:00 p.m.

\$44.00

The DoSeum is San Antonio's only museum just for children where kids learn by doing, creating and tinkering – instead of just looking and listening. With interactive exhibits, it is regarded as one of the most state-of-the-art learning facilities in the United States. Highlights include an interactive robot named Baxter, a spy academy filled with math challenges, an interactive puppet parade, a musical staircase, a Children's River and outdoor areas with water features. A must do for kids of all ages!



## SATURDAY, MARCH 4

### Ranger Creek Distillery

Saturday, March 4: 1:00 p.m. - 4:30 p.m.

\$65.00

*Repeat, see Wednesday description*

### Architectural Splendors of San Antonio's Past

Saturday, March 4: 1:00 p.m. - 5:00 p.m.

\$67.00

San Antonio's German influence is best captured in magnificent homes located in the historic King William District. Established in the 1870s when wealthy German merchants and professionals built grand homes along the main street named after Kaiser Wilhelm I, King of Prussia. Visits will include the Guenther House, an elegantly restored home that was the site of the first flourmill. Next, the tour will visit the Victorian era, Edward Steves Homestead, complete with 3-story limestone mansion. The tour will then travel to Villa Finale, an ornate 19th century house, once owned and restored by Walter Mathis. Interpretive guides will lead the tour of the 6,500 square-foot home and its collection of fine and decorative arts. As the tour winds its way to La Villita, one of the earliest settlements in San Antonio, guests will view the Spanish Governor's Palace and the San Fernando De Bexar Cathedral.



### Cruising Through History

Saturday, March 4: 1:00 p.m. - 5:00 p.m.

\$35.00

*Repeat, see Wednesday description*

## Natural Bridge Caverns

Saturday, March 4: 1:00 p.m. - 5:00 p.m.

\$58.00

Let's head into the rolling Hill Country for an underground adventure! Natural Bridge Caverns, recently voted one of the top ten caves of the United States, is a short bus ride from San Antonio. Except for the lighting, walkways and handrails, you will find the North Cave much the same as the discoverers did in 1960. See awe-inspiring, ancient formations centuries in the making and still growing today, such as amazing stalagmites, stalactites, and more.



### Rafting on the Guadalupe River

Saturday, March 4: 1:00 p.m. - 5:00 p.m.

\$97.00

Enjoy a nice slow float under a canopy of cypress trees along the Guadalupe River. Rockin' R River Rides is located in the historic town of Gruene. The lazy river is waiting for everyone to select a 2-person canoe or 4-person raft as you set off for a leisurely 2-hour float down the river. There are curves, bends, rapids and great scenery on this afternoon of fun. Guides will assist with the float and escort the group throughout the entire course.



Note: Everyone must wear some sort of shoes (i.e. tennis shoes) and know how to swim. Bring a towel and a dry change of clothes.

### San Antonio Missions

Saturday, March 4: 1:00 p.m. - 5:00 p.m.

\$50.00

The San Antonio Missions tell the story of the European expansion in the New World and is a newly honored UNESCO World Heritage Site. The tour begins at the most famous of the missions: The Alamo. Next, the tour journeys to Mission San Jose. Established in the 1700s, it is the largest of the San Antonio's five missions. San Jose's church is one of the most beautiful in the country with its elaborate carvings on the chapel façade. We will view Espada Dam, originally built curving the wrong way yet has endured floods for more than 200 years. The third stop, Mission San Juan Capistrano, made its permanent home along the San Antonio River in 1731. The guide will discuss the two remaining missions: Mission Espada, which was established in 1731 but was never completed and Mission Concepcion the oldest unrestored mission church in Texas.



### Sandy Oaks Olive Orchard

Saturday, March 4: 1:00 p.m. - 5:00 p.m.

\$97.00

When you step out of the bus, you will think you are in Tuscany when you see the rolling fields of olive trees and stately oaks at Sandy Oaks Olive Orchard. Sandy Winokur, owner and manager, will greet you and take you for a wonderful tour where you will see 10,000 olive trees in more than 30 varieties. Along the way, you will hear how she pioneered the art of growing olives in Texas, the many benefits of olive oil, plus all of the products that can be made from the leaves. She will lead you through an introductory sampling of olive oils, explaining their flavor complexities, such as fruitiness, bitterness and pepperiness! Discover the secrets to understanding labels and concepts as well as the health benefits of olives.



# 20 ways

## To Make Your Commodity Classic Experience a Great One!

- 1) Register and make your travel plans early!
- 2) Use the floor plan in your program to plan your attack on the trade show floor so you don't miss something important to you.
- 3) Go through the registration packet you get on site to check on all the cool deals, special events and giveaways.
- 4) Wear comfortable shoes. The trade show is huge!
- 5) Get a good seat for the General Session on Friday morning.
- 6) Introduce yourself to a farmer from another part of the country—and share information and ideas.
- 7) Sit in on one of the open sessions of your commodity membership association.
- 8) Raise your hand and ask a question at a Learning Center Session.
- 9) Set your alarm and attend an Early Riser Session.
- 10) Attend a What's New or Mini What's New session to be among the first to hear about the latest innovations.
- 11) Download the Commodity Classic app to your smart phone or tablet for updates and information at your fingertips.
- 12) Sign up today for email updates so you can keep current on what's going to take place in San Antonio. Visit [CommodityClassic.com](http://CommodityClassic.com)
- 13) Come into San Antonio a day early to join one of several unique tours of the area.
- 14) Bring some business cards so you can hand them to people you meet.
- 15) Attend the live taping of U.S. Farm Report on Friday morning.
- 16) Enjoy the Evening of Entertainment on Saturday featuring Pat Green.
- 17) Carry a notepad and pen. There's a lot of information to gather!
- 18) If this is your first Commodity Classic, visit the "First Time Attendees" page at [CommodityClassic.com](http://CommodityClassic.com) to get the inside scoop.
- 19) Bring a fellow farmer, hired hand or family member so you can attend more educational sessions and compare notes.
- 20) Have some fun! You deserve it.

# Download the 2017 Commodity Classic app

Everything you need in the palm of your hand—seminar schedules, trade show layout, exhibitor contacts and more. Visit [CommodityClassic.com](http://CommodityClassic.com) to download the app.



# REGISTRATION Info

## Registration Info

Come to the Commodity Classic registration area beginning Wednesday, March 1, to pick up your registration packet, name badge, event program and meal tickets. The Commodity Classic Registration Desk will be located in the West Registration Lobby of the Henry B. González Convention Center.

### Full Registration Includes:

- Trade Show access, including a fiesta reception on Thursday, lunch on Friday and a morning snack on Saturday in the Trade Show
- General Session
- Educational Sessions: Learning Centers, Early Riser Sessions, What's New Sessions and Mini What's New Sessions
- Main Stage Presentations in the Trade Show
- Complimentary access to video recordings of the 2017 Learning Centers, What's New sessions and some Early Risers sessions (keep your badge ID for access)
- ASA or NCGA Banquet (based on space availability and is not guaranteed)
- Evening of Entertainment
- For growers, grower-family members, media or commodity organization national or state staff: full registration also includes the Welcome Reception. Register by January 12 to receive a free drink ticket redeemable at the Welcome Reception on Wednesday, March 1.

**One-Day Registration Includes:** The events above that occur on your registered day, with the exception of association banquets. Educational session recordings are complimentary only for the day that you are registered.

## Convention Registration Cancellation Policy

Full refund, less \$25 per person administration fee, will be granted on written request through January 26, 2017. Questions: Call (800) 465-0482. Email: attendee@CommodityClassic.com

## Important Registration Dates:

- ASA or NCGA Banquet tickets are subject to availability and are not guaranteed
- January 12:** Early registration discount ends
- January 13-26:** Regular registration rates apply
- After January 26:** Late registration rates apply
- January 26:** Registration cancellation must be requested in writing by this date
- February 8:** Tours pre-registration deadline
- February 8:** No tour refunds after this date
- March 1:** Convention on-site registration begins

## Important Housing Dates:

- January 12:** Rooms must be cancelled by January 12 to avoid a charge of one night's room and tax
- February 8:** Hotel group rates guaranteed through today
- February 8:** Hotel changes and cancellations for all hotels must be made through the housing bureau by this date
- After February 13:** Contact hotels directly with changes and cancellations

Commodity Classic registration and housing operate on a first-come, first-serve basis and is not guaranteed.

## Join and Save!

Save \$100 on the non-member Full Registration by joining today one of these commodity associations. In some cases, these savings may be more than the cost of membership!

- American Soybean Association: (314) 576-1770
- National Corn Growers Association: (636) 733-9004
- National Association of Wheat Growers: (202) 547-7800
- National Sorghum Producers: (806) 749-3478

## Win a John Deere® Gator™!

Growers that complete their demographic information while registering are automatically entered into a drawing for a Gator™XUV825i, sponsored by John Deere. The drawing will be held on Saturday, March 4 at 10:15 a.m. in the John Deere booth #3133.

## What is RFID?

Radio-frequency identification (RFID) is used at Commodity Classic to track attendance at educational sessions and other events. Your name badge contains coded information unique to you that is read by the RFID technology.

Some exhibitors may use RFID technology to capture your demographic information at their trade show booths to eliminate the need for you to take time to fill out a form.

By registering for Commodity Classic, you consent to the use of RFID by Commodity Classic and its exhibitors.

## Canadian Anti-Spam Legislation

To our Canadian attendees: we would like to stay in touch with you. As per the Canadian Anti-Spam Legislation, please provide your consent to receive email communications from Commodity Classic. Please visit CommodityClassic.com for a consent form.

### Visit CommodityClassic.com to register for:

- Convention/trade show
- Housing
- Tours

**NOTE:** You must register separately for each of the above. The form below is for convention/trade show registration only.

facebook.com/CommodityClassic

@ComClassic  
#Classic17  
#FarmerUp

Whether you're a veteran attendee or if you've never been to the show before, Commodity Classic offers exciting, new experiences for everyone. Register by January 12 to receive the early registration rate!

TRIM ALONG DOTTED LINE

ONE FORM PER HOUSEHOLD

**BADGE INFORMATION**  
Please print name to appear on badge.  
Membership number is required to receive the member rate.

MEMBERSHIP NUMBER

FIRST NAME LAST NAME  
CO./FARM  
ADDRESS  
CITY STATE ZIP  
PHONE FAX  
REGISTER WITH: FIRST NAME LAST NAME EMAIL EMAIL  
CHILD/YOUTH/COLLEGE FIRST NAME LAST NAME DOB (DAY/MO/YR)  COLLEGE STUDENT  
CHILD/YOUTH/COLLEGE FIRST NAME LAST NAME DOB (DAY/MO/YR)  COLLEGE STUDENT

Includes an Association Banquet\*  CHECK ONE

FULL REGISTRATION	BY		AFTER		ASA Banquet	NCGA Banquet	NONE	Number Registered	SUBTOTAL
	JAN 12	JAN 26	JAN 13-26	JAN 26					
Member Primary	\$190	\$215	\$240	\$240	<input type="checkbox"/>	<input type="checkbox"/>	<input type="checkbox"/>		
Non-Member Primary	\$290	\$315	\$340	\$340	<input type="checkbox"/>	<input type="checkbox"/>	<input type="checkbox"/>		
Spouse	\$145	\$165	\$190	\$190	<input type="checkbox"/>	<input type="checkbox"/>	<input type="checkbox"/>		
Youth/College Age 15-22	\$50	\$50	\$50	\$50	<input type="checkbox"/>	<input type="checkbox"/>	<input type="checkbox"/>		
Child Age 14 and under	NC	NC	NC	NC	<input type="checkbox"/>	<input type="checkbox"/>	<input type="checkbox"/>		
<b>SUBTOTAL FULL REGISTRATION: \$</b>									
<b>ONE-DAY REGISTRATION† (CHECK ONE)</b>									
Thursday Member	\$105	\$120	\$140	\$140					
Thursday Non-Member	\$150	\$160	\$180	\$180					
Friday Member	\$105	\$120	\$140	\$140					
+Optional Banquet	\$50	\$50	\$65	\$65	<input type="checkbox"/>	<input type="checkbox"/>	<input type="checkbox"/>		
Friday Non-Member	\$150	\$160	\$180	\$180					
+Optional Banquet	\$50	\$50	\$65	\$65	<input type="checkbox"/>	<input type="checkbox"/>	<input type="checkbox"/>		
Saturday Member	\$75	\$75	\$75	\$75					
Saturday Non-Member	\$105	\$105	\$105	\$105					
<b>SUBTOTAL ONE-DAY REGISTRATION: \$</b>									
<b>TOTAL REMITTANCE \$</b>									

\*ASA and NCGA banquets are being held concurrently and availability is limited on a first-come, first-served basis.  
†One-day registration includes program events scheduled for that day excluding association banquet tickets.  
Optional banquet tickets are available for Friday's program and maybe purchased on a first-come, first-served basis.

**REGISTRATION PAYMENT**  
Form and full payment must be faxed or postmarked by January 12 to receive registration discount.

Check Enclosed (Payable in U.S. funds to Commodity Classic)

MasterCard  
 Visa  
 American Express  
 Discover

Credit Card# (Please do not email credit card information)

Signature

Exp. Date

PROMO CODE  
IF APPLICABLE

By attending Commodity Classic 2017, you agree that Commodity Classic, its employees, contractors and volunteers, may photograph, videotape or audiotape you during the Conference and related activities. Your photo, video, audio, likeness or image may be used by Commodity Classic for promotional or related purposes with no remuneration to you. By participating in Commodity Classic 2017, you consent to the use of RFID by Commodity Classic and exhibitors. (See information in registration brochure regarding RFID.)

By registering for the conference, you agree that Commodity Classic may share the information contained on your registration form with sponsors, exhibitors and other participants in Commodity Classic 2017. If you do not wish to have your email address shared with sponsors, please indicate so in the box below:

I DO NOT WISH TO HAVE MY EMAIL ADDRESS SHARED WITH SPONSORS, EXHIBITORS AND OTHER COMMODITY CLASSIC PARTICIPANTS.

**Send form & payment to:**  
Commodity Classic • 5202 Presidents Court • Frederick, MD 21703 • Fax: (888) 772-1888



## 2017 Registration

Register online:  
www.CommodityClassic.com  
Questions: Call (800) 465-0482  
Email: Attendee@CommodityClassic.com

## Association Membership

Check all that apply. If you check more than one, CIRCLE the one you consider your primary commodity association.

- American Soybean Association
  - National Corn Growers Association
  - National Association of Wheat Growers
  - National Sorghum Producers
- Check all that apply:
- First-time attendee
  - Member grower
  - Non-member grower
  - Exhibitor
  - Non-exhibitor corporate
  - Media
  - State staff of ASA, NCGA, NAWG or NSP

## GROWERS ONLY

Win a John Deere™ XUV825i Gator!

AGE \_\_\_\_\_ TOTAL FARM ACRES \_\_\_\_\_

CORN ACRES \_\_\_\_\_ SOYBEAN ACRES \_\_\_\_\_

WHEAT ACRES \_\_\_\_\_ SORGHUM ACRES \_\_\_\_\_

PEANUT ACRES \_\_\_\_\_ HAY/FORAGE ACRES \_\_\_\_\_

COTTON ACRES \_\_\_\_\_ NO. OF HOGS \_\_\_\_\_

## NO. OF COW/CALF PAIRS

## NO. OF FEEDLOT CATTLE

**Entry Rules:** Grower entrants must complete the information above. One entrant per family. Drawing will be held Saturday, March 4, 2017 at 10:15 a.m. in the John Deere booth #3133. Do not need to be present to win. If the winner is present at the time of the drawing, they will receive a \$500 gift certificate toward the purchase of accessories for the XUV825i Gator. Employees of ASA, NCGA, NSP, NAWG, AEM or John Deere are ineligible. All applicable federal, state and local taxes on the prize are the responsibility of the winner. The prize is non-transferable and no cash or other substitution in part or in whole will be involved. The John Deere vehicle is equipped at John Deere's discretion. Any implements, attachments or feature deviation will be at the winner's expense.

## Special Services

- Check here & describe if you or your guest have special needs
- Check here & describe if you or your guest have special meal requirements

**Cancellation Policy** Full refund, less \$25 per person administration fee, will be granted on written request through January 26, 2017. No refunds after January 26, 2017.